

**LOCTITE***Adhesives for more  
reliable assemblies***APPLICATION CASE HISTORY****No. 107**

# Loctite® 262 Threadlocker Locks Locomotive Traction Motor Mounting Bearing Bolts

**Problem:**

Traction motor mounting bearing bolts are threaded assemblies on the motor that propels the locomotive drive wheels. Previous assembly methods called for bolts to be torqued, lubricated and lock wired. But even with all this care, bolts would loosen and in some instances, drop off.

*Not only would the motor assembly be weakened by a missing bolt, but the danger of train derailment was significant.*

**Solution:**

Loctite 262 Threadlocker is a high strength adhesive designed for extreme environmental/chemical conditions. It's especially useful where Grade 5 and 8 fasteners are subjected to heavy shock, vibration and stress levels. It stays locked securely, yet is removeable with heat and hand tools.

**Results:**

Loctite 262 Threadlocker is now applied to the traction motor mounting bearing bolts in all our customer's drive wheels for to help eliminate the risk of train derailment.

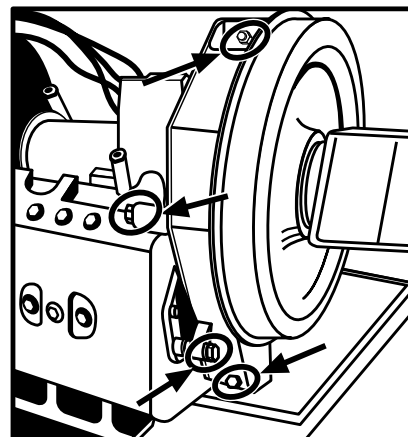
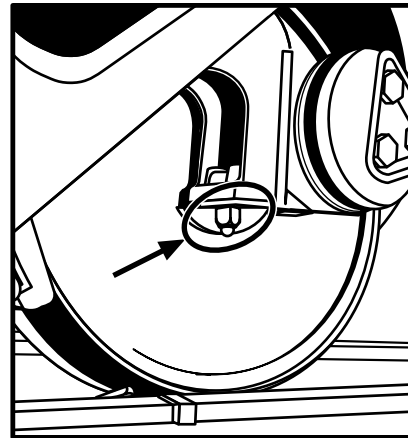
**Loctite Americas**

**U.S.A.**  
Loctite Corporation  
1001 Trout Brook Crossing  
Rocky Hill, Connecticut 06067  
860-571-5100  
Telefax: 860-571-5465

**CANADA**  
Loctite Canada Inc.  
2225 Meadowpine Blvd.  
Mississauga, Ontario L5N 7P2  
800-263-5043 (within Canada)  
905-814-6511  
Telefax: 905-814-5391

**MEXICO**  
Loctite Company de México, S.A. de C.V.  
Calzada de la Viga s/n, Fracc. Los Laureles  
Loc. Tulpetlac, C.P. 55090  
Ecatepec de Morelos, Edo. de México.  
01-800-8499-412  
Telefax: 011-525-787-9404